

ITEM	QTY.	P/N	DESCRIPTION
1	1	200-2109	ASSEMBLY, HEADSTOCK
2	1	225-2000	ASSEMBLY, COVER, HEADSTOCK
3	1	300-2000	ASSEMBLY, TAILSTOCK
4	1	500-2009-1	ASSEMBLY, SKID

BUCKING UNIT SPECIFICATIONS		
MAX TORQUE	10,000 ft-lbs	13,558 N-m
SYSTEM PRESSURE	3,000 PSI	207 Bar
ARM LENGTH	13 Inches	33.02 cm
MASS	4,200 Lbs.	1,900 kg
SPEED (RPM, ESTIMATED)		
13.6 RPM		
AT FLOW RATE (GPM/LPM):		
26.4 GPM		100 LPM

NUMBER OF JAWS	PIPE SIZE (IN)	TORQUE CAPACITY			
		MAX. TORQUE @ 2,000 PSI (ft-lb)	MAX. TORQUE @ 1,800 PSI (ft-lb)	MAX. TORQUE @ 1,500 PSI (ft-lb)	MAX. TORQUE @ 1,000 PSI (ft-lb)
3 JAWS	9.000	10,000	10,000	10,000	7,200
	8.500			6,800	
	7.625			6,100	
	6.625	8,700	9,500	7,900	5,300
	5.500			6,600	4,400
	5.000	8,000	7,200	6,000	4,000
	4.500	7,200	6,400	5,400	3,600
	4.000	6,400	5,700	4,800	3,200
	3.500	5,600	5,000	4,200	2,800
	3.000	4,800	4,300	3,600	2,400
	2.875	4,600	4,100	3,400	2,300
	2.375	3,800	3,400	2,800	1,900
1.660	2,600	2,400	2,000	1,300	

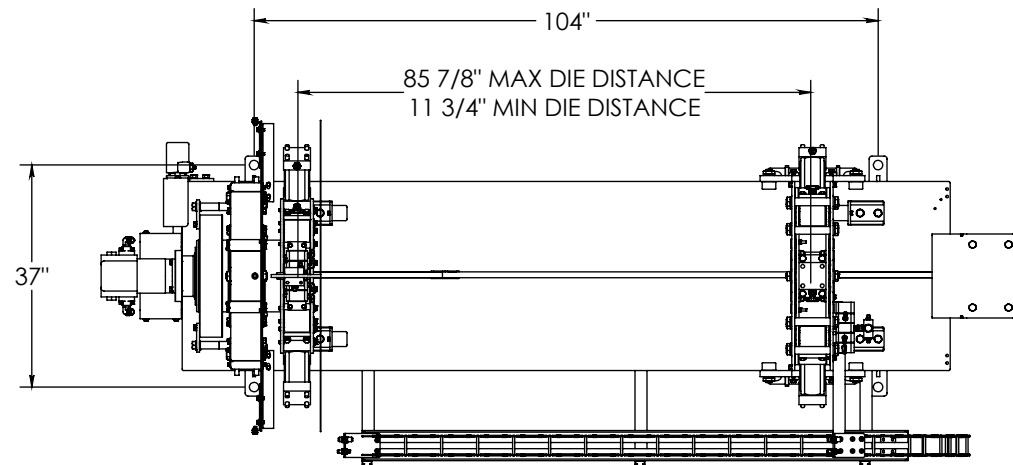

SOME COMPONENTS HIDDEN FOR CLARITY

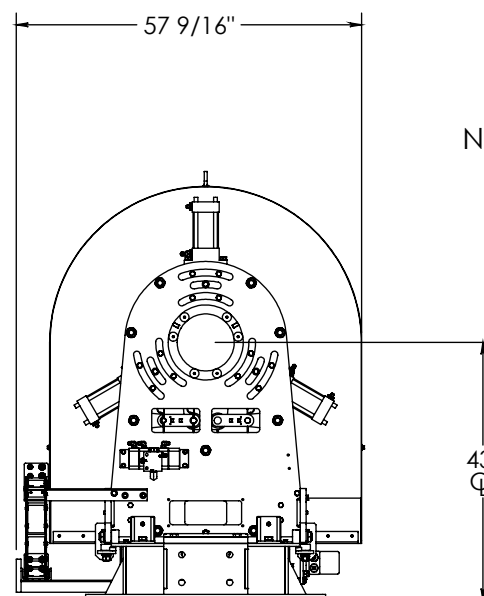
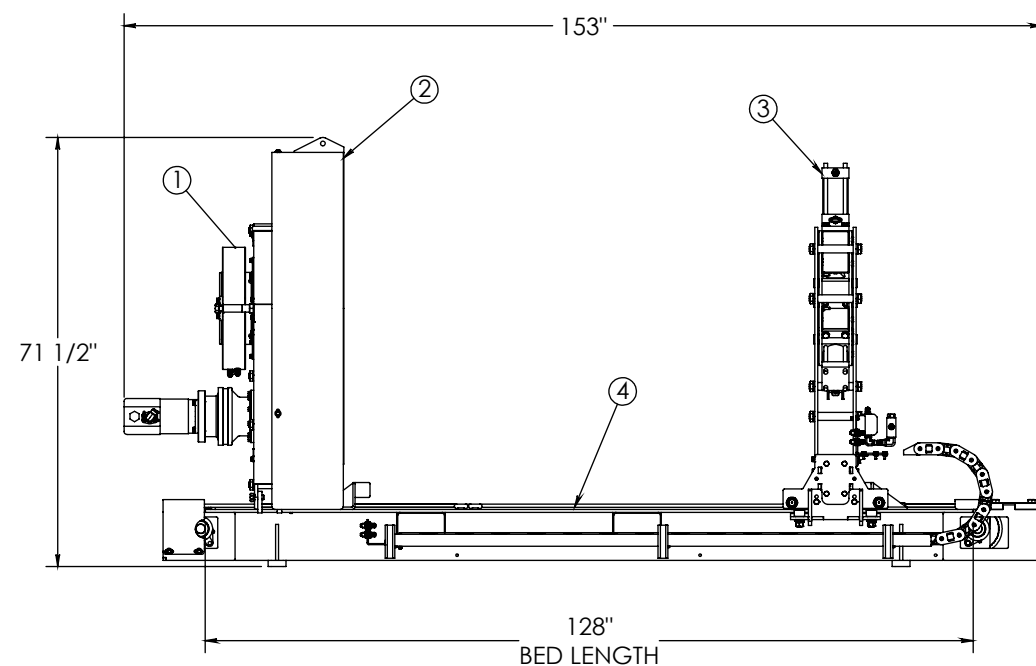

NOTES:

- 1) THIS TABLE REPRESENTS THE THEORETICAL TORQUE AT WHICH THE DIES WILL SLIP ON THE TUBULAR
- 2) THIS UNIT REQUIRES AN RP5047-2XXX MODEL CONTROL CONSOLE TO OPERATE

REVISIONS				
REVISION	ECO NUMBER	ECO DESCRIPTION	ECO COMPLETED BY	ECO COMPLETED DATE
A	14-0339	SEE ECO14-0339	R. CENAC	6/13/2012
B	17-0111	UPDATED GA TO NEW FORMAT	J. KELLY	2017

  

UNLESS OTHERWISE SPECIFIED:		PROPRIETARY STATEMENT			
1. DIMENSIONS ARE IN INCHES		THIS DOCUMENT IS THE PROPERTY OF MCCOY CORPORATION AND IS CONSIDERED CONFIDENTIAL. THIS INFORMATION MAY NOT BE USED, DISCLOSED, COPIED, OR REPRODUCED IN ANY FORM, WITHOUT THE EXPRESS WRITTEN CONSENT OF MCCOY CORPORATION.		DESCRIPTION	
2. TOLERANCES: ANGULAR ± 1° FRACTIONAL ± 1/16 TWO PLACE DECIMAL ± 0.02 THREE PLACE DECIMAL ± 0.005		DRAWN R. HENRY 09/22/2016		ASSEMBLY, BUCKING UNIT, 9.0-10K	
3. IDENTIFY P/N & MAIL P.O. USING 1/8 TO 1/4 ETCHED LETTERS, DENOTED BY "X"		CHECKED JK 9/23/2016		SIZE PART NO.	
4. REMOVE BURRS & SHARP EDGES WITH 1/64x45° MAX		APPROVED BP 9/23/2016		RP2109	
5. MACHINED FILET RADII SHALL BE 1/32		THIRD ANGLE PROJECTION		MATERIAL	
6. FINAL SURFACE ROUGHNESS AVG. (Ra) SHALL BE ≤ 250 MICROINCHES		WEIGHT 4150 LBS.		N/A	
7. DISNOTES CRITICAL DIMENSION: 100% INSPECTION REQUIRED		REV B		SHEET 1 OF 2	
8. A TRIANGLE DENOTES A REVISION					
9. INTERPRET DRAWING PER ASME Y14.5-2009					

RELEASED FOR PRODUCTION

# STANDARD ACCESSORIES

HYDRAULIC SUPPORT STAND

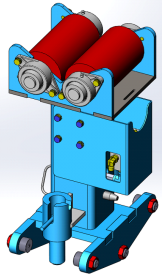

HYDRAULIC POWERED V-ROLLER SUPPORT STAND

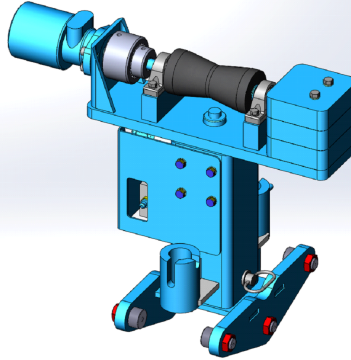

HYDRAULIC NON-POWERED V-ROLLER SUPPORT STAND

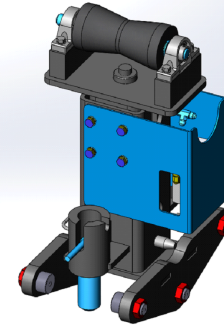

HYDRAULIC TRANSFER BALL ROLLER SUPPORT STAND

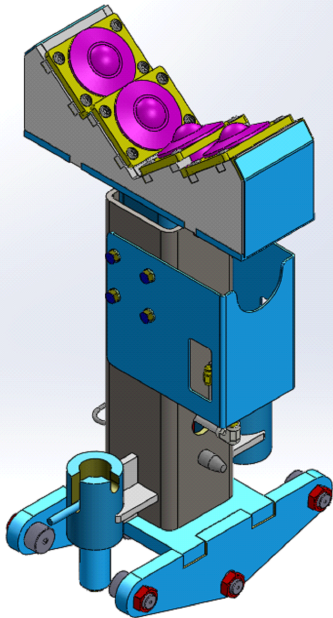

PUSH PULL

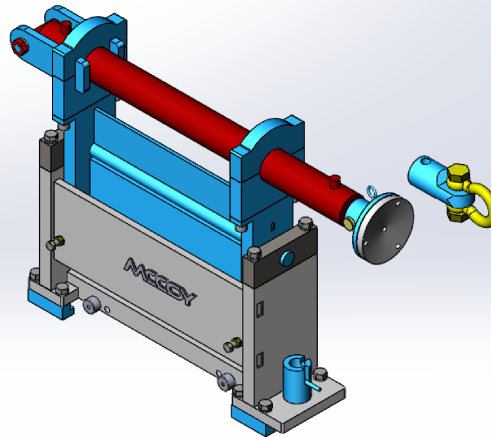

EXTENSION BEAM  
(AVAILABLE FROM 6' TO 20')

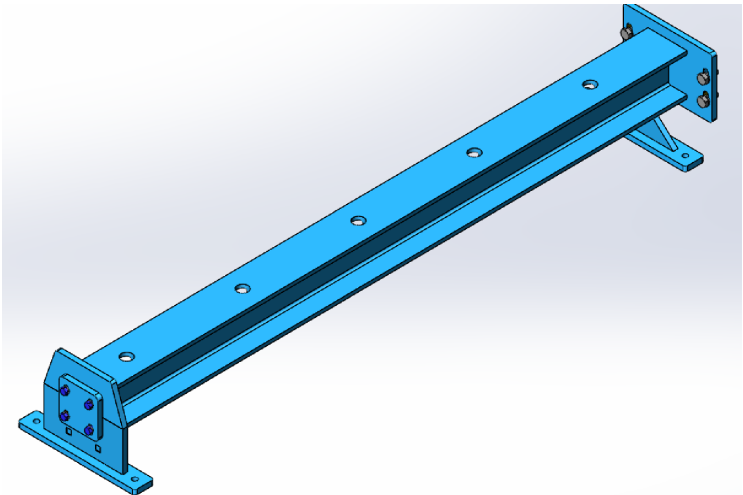

DESCRIPTION		
ASSEMBLY, BUCKING UNIT, 9.0-10K		
SIZE	PART NO.	REV
A	RP2109	B
MATERIAL		SHEET 2 OF 2
N/A		