

**RP5047-7006 SPECIFICATIONS**

POWER REQUIREMENT	3 PHASE 480 V, 60 Hz	3 PHASE, 380 V 50 Hz	3 PHASE, 240V, 50 Hz
FULL LOAD / INRUSH CURRENT	59.2 A / 213 A	74.8 A / 269 A	118 A / 426 A
MAXIMUM OPERATING PRESSURE	4200 PSI / 290 BAR		
MAXIMUM MOTOR OUTPUT	50 HP		
MAXIMUM HYDRAULIC FLOW	47 GPM / 178 LPM		
HYDRALUIC RESERVOIR CAPACITY	90 GALLON / 341 L		
OIL REQUIREMENT	AW-68		
SPECIAL FEATURES	11 BANK VALVE		
	COOLER		

**REVISIONS**

REVISION	ECN NUMBER	ECN DESCRIPTION	ECN COMPLETED BY	ECN COMPLETED DATE
A	N/A	INITIAL RELEASE	N/A	N/A
B	17-0101	ADDED GA SPECIFICATION SHEET; REPLACE (1) RPVBADPM W/ (1) RPVBADPM-S	M.BUDDEN	5/16/2017

UNLESS OTHERWISE SPECIFIED:  
 1. DIMENSIONS ARE IN INCHES  
 2. TOLERANCES:  
 ANGULAR ± 1°  
 FRACTIONAL ± 1/16  
 TWO PLACE DECIMAL ± 0.02  
 THREE PLACE DECIMAL ± 0.005  
 3. IDENTIFY P/N & MAIL P.O. USING 1/8 TO 1/4 ETCHED LETTERS; DENOTED BY "X"  
 4. REMOVE BURRS & SHARP EDGES WITH 1/64x45° MAX  
 5. MACHINED FILET RADI SHALL BE 1/32  
 6. FINAL SURFACE ROUGHNESS AVG. (Ra) SHALL BE ≤ 250 MICROINCHES  
 7. DIMENSIONS IN TRIANGLES ARE CRITICAL DIMENSIONS; 100% INSPECTION REQUIRED  
 8. A TRIANGLE DENOTES A REVISION  
 9. INTERPRET DRAWING PER ASME Y14.5-2009

**PROPRIETARY STATEMENT**  
 THIS DOCUMENT IS THE PROPERTY OF MCCOY CORPORATION AND IS CONSIDERED CONFIDENTIAL. THIS INFORMATION MAY NOT BE USED, DISCLOSED, COPIED, OR REPRODUCED IN ANY FORM, WITHOUT THE EXPRESS WRITTEN CONSENT OF MCCOY CORPORATION.

DRAWN	R.CENAC	09/14/2015
CHECKED	J.KELLY	
APPROVED	J.KELLY	

THIRD ANGLE PROJECTION

**MCCOY GLOBAL**

DESCRIPTION  
 ASSEMBLY, POWER UNIT/ CONSOLE, 11 BANK, W/ HEAT EXCHANGER

SIZE PART NO.  
 B RP5047-7006

MATERIAL  
 N/A

REV B

SHEET 1 OF 7

RELEASED FOR PRODUCTION

ITEM	QTY	P/N	DESCRIPTION	ITEM	QTY	P/N	DESCRIPTION
1	3	133-6500	2-1/2" 0-3000 PSI GAUGE	62	8	119	5/16" FLATWASHER
2	1	134-6500	6" 0-5000 PSI GAUGE	63	4	123	SCREW, HEX HEAD, 5/16-18 X 1 1/4, GR8
3	1	135-6500	2-1/2" 0-5000 PSI GAUGE	64	4	1023-B	WASHER, LOCK, 5/16, GR8
4	12	1150-A01	NUT, 6-32, STAINLESS STEEL	65	1	KITFIT-RP5047-7000	FITTING KIT
5	12	1150-C01	#6-32 X 1 1/2" STAINLESS STEEL BOLT	65.1	2	4R6X-S	FITTING, 1/4 FJIC SWIVEL, 1/4 MJIC, RUN TEE
6	1	7000-11	OVERLAY, BANK	65.2	1	1394-A	2" STREET EL. LOW PRESSURE
7	1	CLEBU1210-03	WELDMENT, TRAY, COMPUTER	65.3	1	1463	NIPPLE, HEX, 1 1/4"
8	3	CRSS20033	SCREW, MACHINE, 10-32, 1, STAINLESS STEEL	65.4	2	1562	FITTING, 1/4 MNPT, 1/4 MJIC, STRAIGHT
9	3	CRSS20045	NUT, 10-32	65.5	1	1609-A	PLUG, FLUSH, 1/2"
10	1	D2375	ROD WIPER 2 3/8"ID 2 7/8"OD 3/8"HGT. 1/4"BASE THK.	65.6	1	1610	FITTING, 3/4 MNPT, PLUG
11	1	EBWOO 1R3004A20A120	3P 10A FEM RCPT	65.7	1	1626	FITTING, 1/2 MNPT, 1/2 MJIC, ELBOW
12	1	P563268	FILTER HEAD W/ 1 1/4" FNPT PORTS	65.8	1	2501-12-20	FITTING, 90 DEG. ELBOW, 1 1/4" MNPT X 3/4" MJIC
13	1	PN32-10000	PIPE NIPPLE 2 IN X 10 IN LONG	65.9	1	1467	ADAPTER, 3/4MNPT X 3/4MJIC, STRAIGHT
14	1	RPDV5047-3501	DUMP VALVE ASSEMBLY	65.10	1	12G6X	FITTING, SWIVEL, 3/4 FNPT X 3/4 FJIC, STRAIGHT
14.1	1	58058	VALVE, RELIEF (DUMP), 3/4"	65.11	1	1588	FITTING, 3/4 FNPT, 3/4 FNPT, ELBOW
14.2	1	58058-S	VALVE, DUMP, SOLENIOD, NORMALLY CLOSED, VV01-321-GOO-E1 (24 VOLT)	65.12	1	1652-A	90 1/8" FNPT X 1/8" FNPT
14.3	1	12 F6X	FITTING, SWIVEL, STRAIGHT, 3/4" MNPT X 3/4" FJIC	65.13	1	1486-A	FITTING, O-RING, 1/4 x 1/4 MJIC, 90
14.4	1	1467	ADAPTER, 3/4MNPT X 3/4MJIC, STRAIGHT	65.14	1	1679	HEX NIPPLE, REDUCING, 1 MNPT X 3/4 MNPT
14.5	1	12CTX	FITTING, 3/4 MNPT, 3/4 MJIC	65.15	1	PN32-C	FITTING, 2 MNPT, 2 MNPT, CLOSE, STRAIGHT, SCH 40 PIPE NIPPLE
15	3	RPVBADPM-S	ASSEMBLY, RELIEFE VALVE	65.16	4	1725-A	FITTING, 3/8 MORB, 1/4 FNPT, STRAIGHT
16	2	SEC-12	COVER, CLEANOUT	65.17	4	RP6801-NWO-4-6	FITTING, 90 DEG. ELBOW, 1/4" MJIC X 3/8" MORB
17	24	SST-08	SCREW, BUTTON HEAD, 1/4-20/ 3/4	65.18	4	6-10F5OX-S	FITTING, STRAIGHT, 3/8 MJIC, #10MSAE
18	2	1404	FITTING, 3/4 MNPT, 3/4 MNPT, 8, STRAIGHT, SCH80	65.19	2	8-10F5OX-S	FITTING, 1/2 MJIC, 5/8 MSAE (#10), STRAIGHT
19	1	PU4060-S33	SWITCH, FLOAT, 1/4 MNPT	65.20	4	2406-12-4	FITTING, REDUCER, 3/4" FJIC X 1/4" MJIC
20	8	1048	SCREW, HEX, 3/8 - 16, 1 1/4, STEEL, GR8	65.21	8	6400-12-12-O	FITTING, 3/4" MORB X 3/4" MJIC, STRAIGHT
21	16	1025	WASHER, FLAT, 3/8, STEEL, GR 8	65.22	7	4-5 f50x-s	FITTING, 1/2 MSAE x 1/4 MJIC STRAIGHT
22	8	213	NUT, NYLOCK, 3/8-16, GR8	65.23	16	6WTX-WLN-S	FITTING, 3/8 MJIC, 3/8 MJIC, STRAIGHT, BULKHEAD
23	1	RPTAG1	CLOCKWISE ROTATIONAL STICKER	65.24	4	8WTX-WLN-S	FITTING, 1/2 MJIC, 1/2 MJIC, STRAIGHT, BULKHEAD
24	2	173-6500	TUBE, UPRIGHT	65.25	6	12-WTX-WLN-S	FITTING, BULKHEAD, 3/4 INCH MJIC X MJIC
25	2	108	SCREW, HEX HEAD, 1/4-20, 1 3/4	65.26	16	1636	CAP, JIC, 3/8
26	2	212	NUT, NYLOCK, 1/4 - 20	65.27	10	1637	CAP, JIC, 1/2
27	14	1737	NUT, NYLOCK, 1/4-20 SS	65.28	6	12-8TRTXN-S	FITTING, ADAPTER, 3/4 FJIC, 1/2 MJIC, 2-PC DESIGN
28	1	PN20-7500	FITTING, 1 1/4 MNPT X 1 1/4 MNPT, 7.5 IN, STRAIGHT, SCH 80 (PIPE NIPPLE)	65.29	5	4-4GTX	1/4" MJIC X 1/4" FNPT
29	1	P165875	FILTER ELEMENT	65.30	1	8-10C5OX-S	FITTING, 5/8 MORB, 3/8 MJIC, 90 DEG
30	1	RP04-200	2" SWING CHECK VALVE (FLAPPER VALVE)	65.31	1	12CTX	FITTING, 3/4 MNPT, 3/4 MJIC
31	1	LFT-134-2	GAUGE FILTER 2 IN FACE 60 PSI .125 NPT	65.32	4	4-6F5OX-S	FITTING, 3/8 MORB, 1/4 MJIC, STRAIGHT
32	1	PN2-0300	PIPE NIPPLE, .125 X 3 MNPT, SCH 80	65.33	5	12R6X-S	FITTING, RUN TEE, 3/4" FJIC X 3/4" MJIC
33	1	PU2500-H6	Pump/ Motor Mounting Adapter SAE C 4 bolt x 7.62" long	65.34	4	6WFTX-S	FITTING, BULKHEAD, 3/8" MNPT X 3/8" MJIC
34	1	7003638	HYDRAULIC PUMP 75cc, LS JRRO75C-LS-21-20-NN-N-3-S1N2 -A2N-NNN-NNN-NNN	66	1	KITHOSE-3502	HOSE KIT, RP STYLE HPU/ CONTROL CONSOLE ASSY (CONTINUOUSLY ROTATING HEAD)
35	1	PU2500-H18	SHAFT COUPLING, PUMP, 14T, 12/24 SPLINE, MfgNo : M500A1412C	67	1	100-6500-13	CONSOLE, RP STYLE, W/ COOLER MOUNT
36	1	570H	HYTREL INSERT (SPIDER)	68	1	RP480-A202010LP-01	BOX, ELECTRICAL, 380V TO 480V, W/ HEAT EXCHANGER STARTER
37	1	PU4060-s6	MOTOR SHAFT COUPLING	69	1	PU2500-H21-01	HEAT EXCHANGER F/ EX. PROOF ELECTRIC MOTOR W/3 PHASE MOTOR W/MOUNTING
38	1	2STRAINER	STRAINER, SUCTION, 2 FNPT	70	2	RP2700-12-12	FITTING, 3/4 MJIC, 3/4 MIC, STRAIGHT, BULKHEAD
39	1	W43-32-32U	FLANGE KIT 2" FNPT	71	2	2406-20-12	FITTING, REDUCER, 1 1/4" FJIC X 3/4" MJIC
40	1	W43-16-16U	FLANGE KIT, 1 FNPT, CODE 61	72	4	1112	SCREW, HEX, 1/2-13, 1 1/2
41	4	202	SCREW, HEX, 5/8-11, 2 1/2, STEEL, GR8	73	4	1102	WASHER, FLAT, 1/2, STEEL, GR08
42	8	195-A	FLATWASHER, 5/8	74	4	1087	NUT, NYLOCK, 1/2-13
43	8	1151	LOCKWASHER, 5/8, STEEL, GR8				
44	4	194	NUT, HEX, 5/8-11, STEEL, GR8				
45	1	CVH05-0750N	3/4 CHECK VALVE				
46	1	CBCS500	CONSOLE SHIELD ASSEMBLY				
47	2	12002000	BAR, MOUNTING, HATCH COVER				
48	7	100	NUT, HEX, 1/4-20, GR8				
49	7	101	WASHER, LOCK, 1/4, GR8				
50	7	104	SCREW, HEX, 1/4-20, 3/4				
51	6	SST-18	SCREW, BUTTON HEAD, 1/4-20 X 1, STAINLESS				
52	1	PU4060-S31	GUAGE, LEVEL / TEMPERATURE				
53	1	PU4060-S30	FILLER CAP				
54	1	KITRPEM-01	KIT, MOTOR, ELECTRIC, 50 HP				
55	1	KITFIT-RPEPU	ASSEMBLY, LEVEL SWITCH				
56	1	108-6500-02	PVG 32 VALVE MOUNTING PLATE				
57	1	RPV5047-7000	11 BANK PVG 32 VALVE				
58	4	LSV1-6T-N	VALVE, SHUTTLE				
59	1	152-6500	COVER, BULKHEAD				
60	4	214A	214A				
61	4	124	SCREW, HEX HEAD, 5/16-18 X 1 1/2				

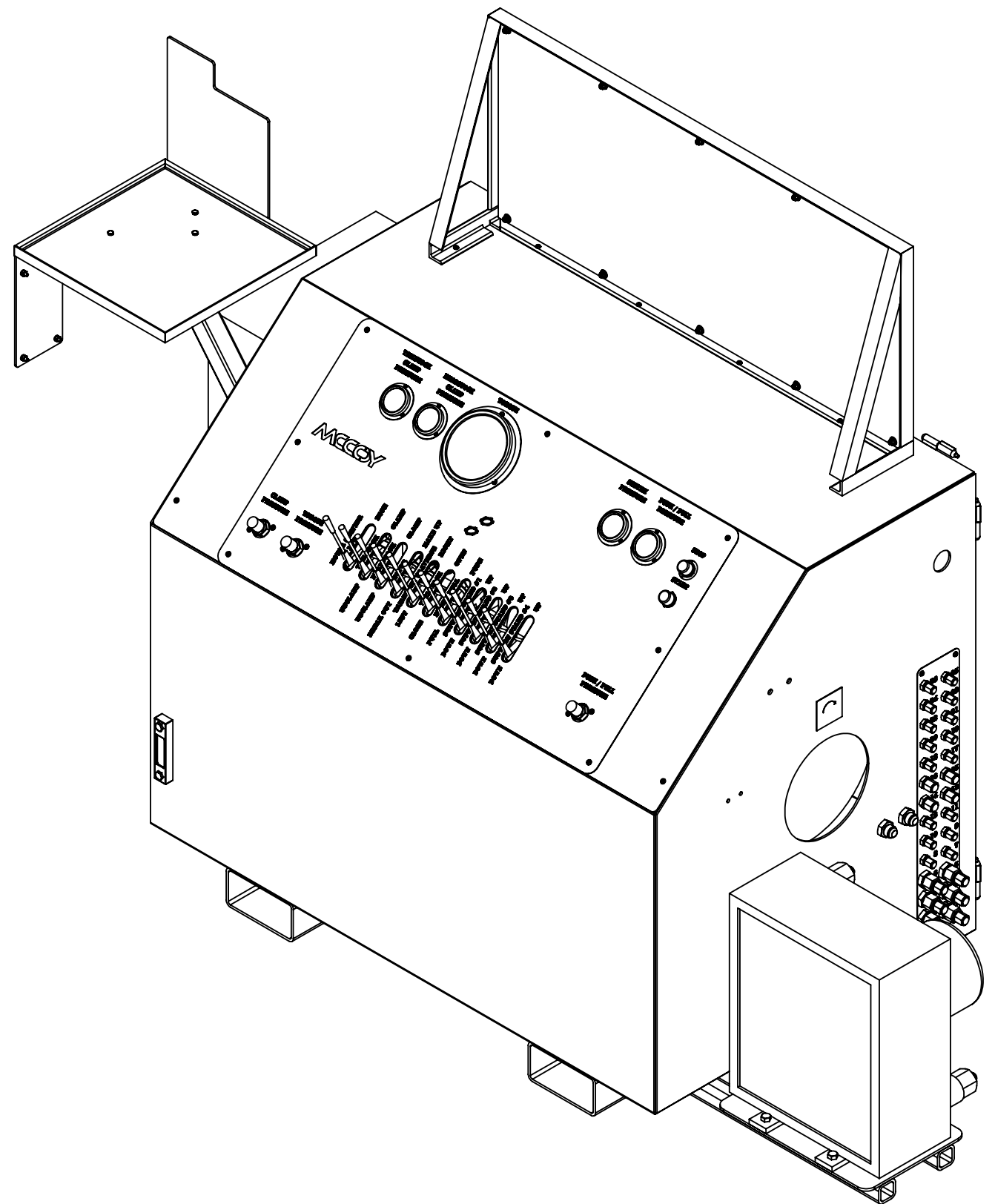

DESCRIPTION			
ASSEMBLY, POWER UNIT/ CONSOLE, 11 BANK, W/ HEAT EXCHANGER			
SIZE	PART NO.	REV	
B	RP5047-7006	B	
MATERIAL		SHEET 2 OF 7	
N/A			

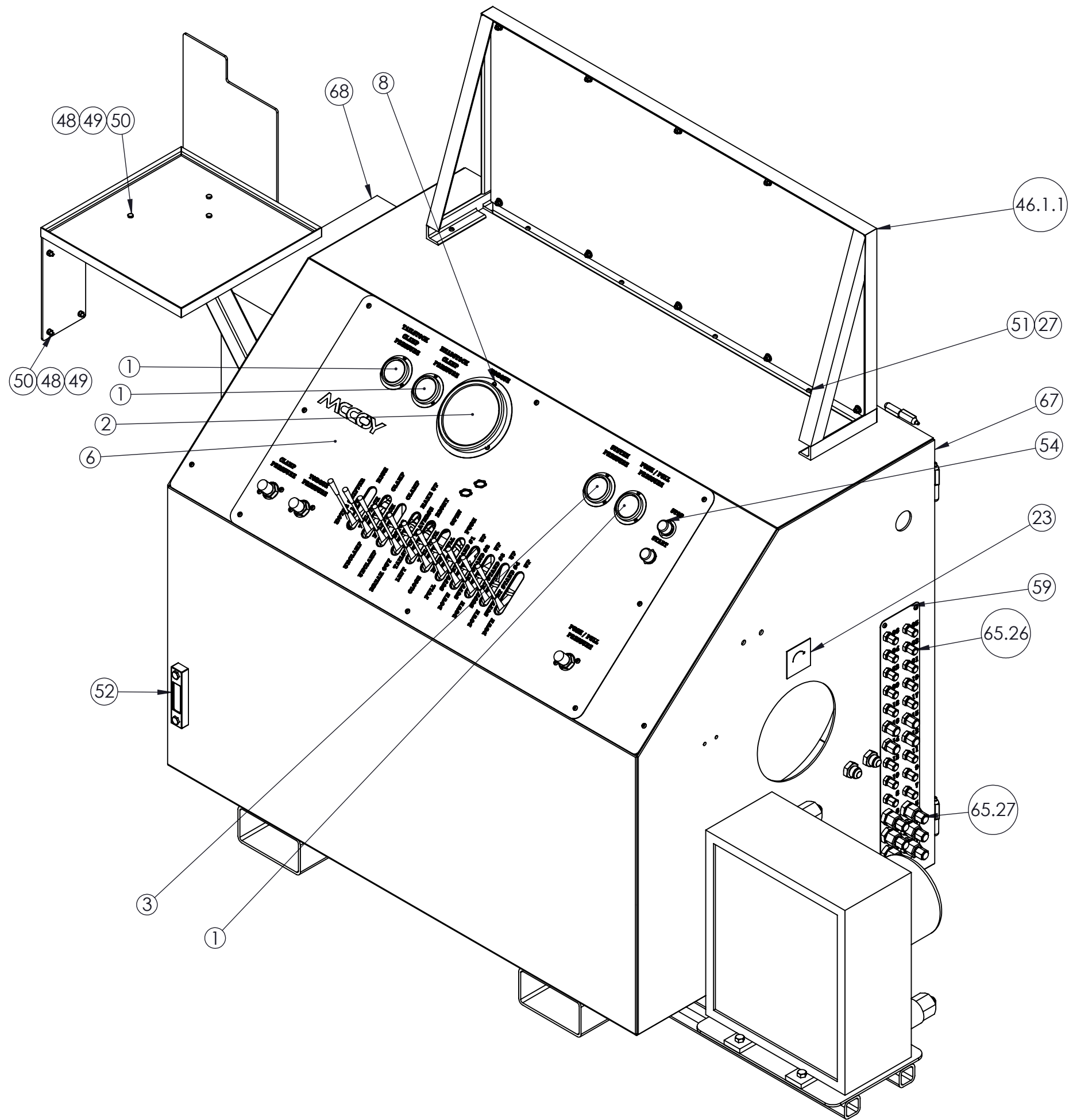

DESCRIPTION			
ASSEMBLY, POWER UNIT/ CONSOLE, 11 BANK, W/ HEAT EXCHANGER			
SIZE	PART NO.	RP5047-7006	REV
B			B
MATERIAL		N/A	SHEET 3 OF 7

SHOWN WITHOUT MULTIPLE PARTS FOR CLARITY

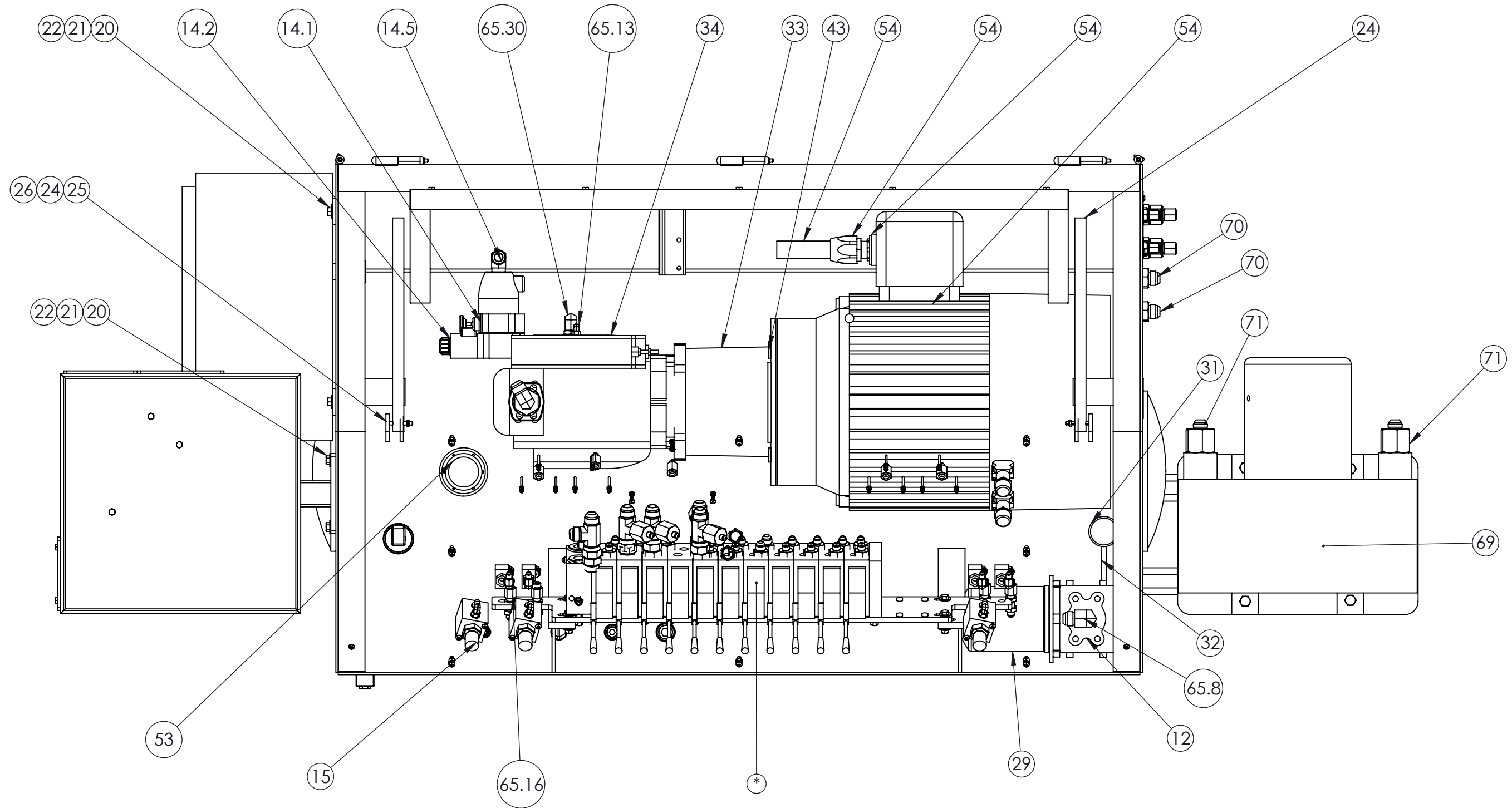

DESCRIPTION			
ASSEMBLY, POWER UNIT/ CONSOLE, 11 BANK, W/ HEAT EXCHANGER			
SIZE	PART NO.	REV	
B	RP5047-7006	B	
MATERIAL	N/A	SHEET 4 OF 7	

SHOWN WITHOUT MULTIPLE PARTS FOR CLARITY

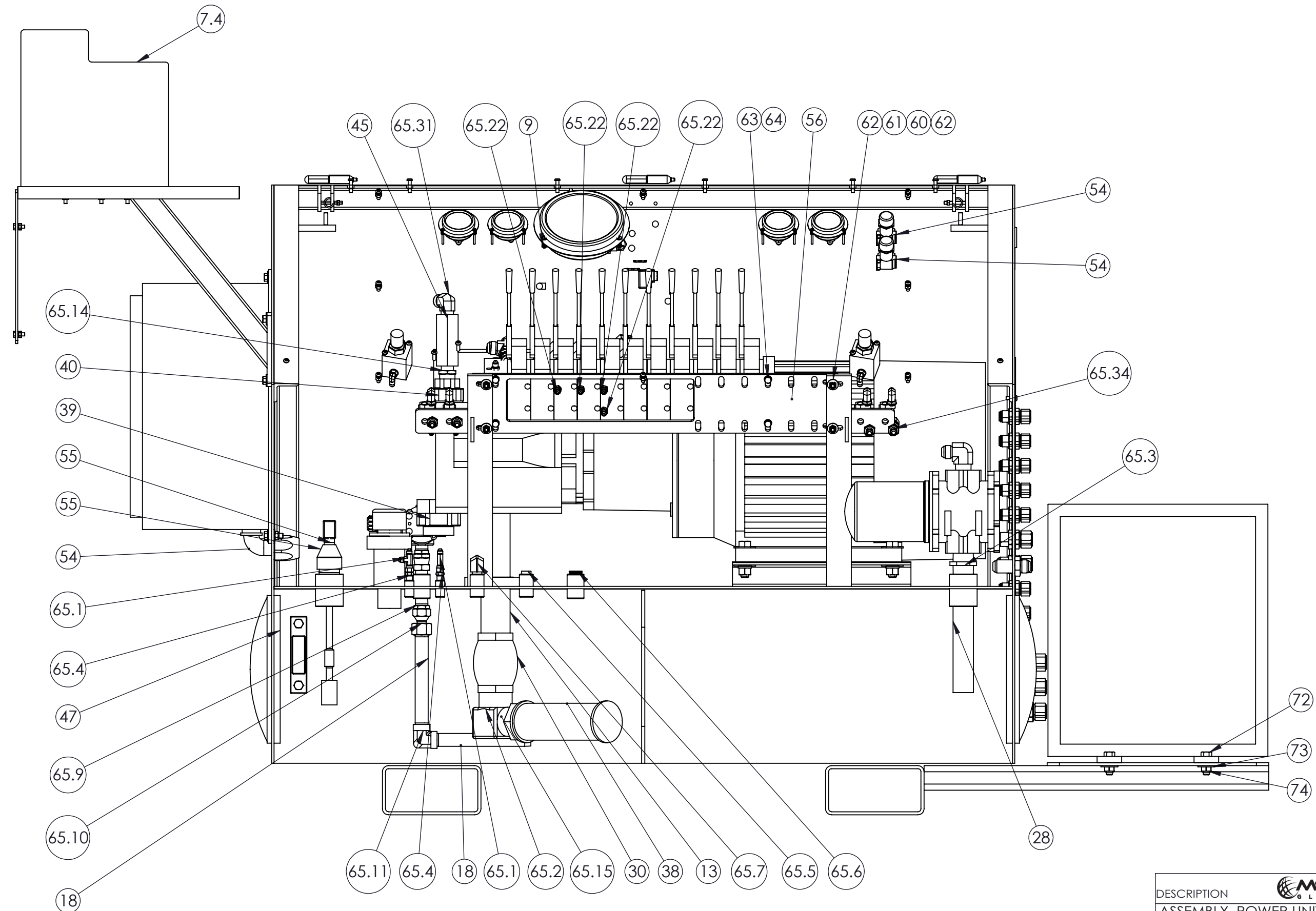

DESCRIPTION			
ASSEMBLY, POWER UNIT/ CONSOLE, 11 BANK, W/ HEAT EXCHANGER			
SIZE	PART NO.	RP5047-7006	REV
B			B
MATERIAL		N/A	SHEET 5 OF 7

SHOWN WITHOUT MULTIPLE PARTS FOR CLARITY

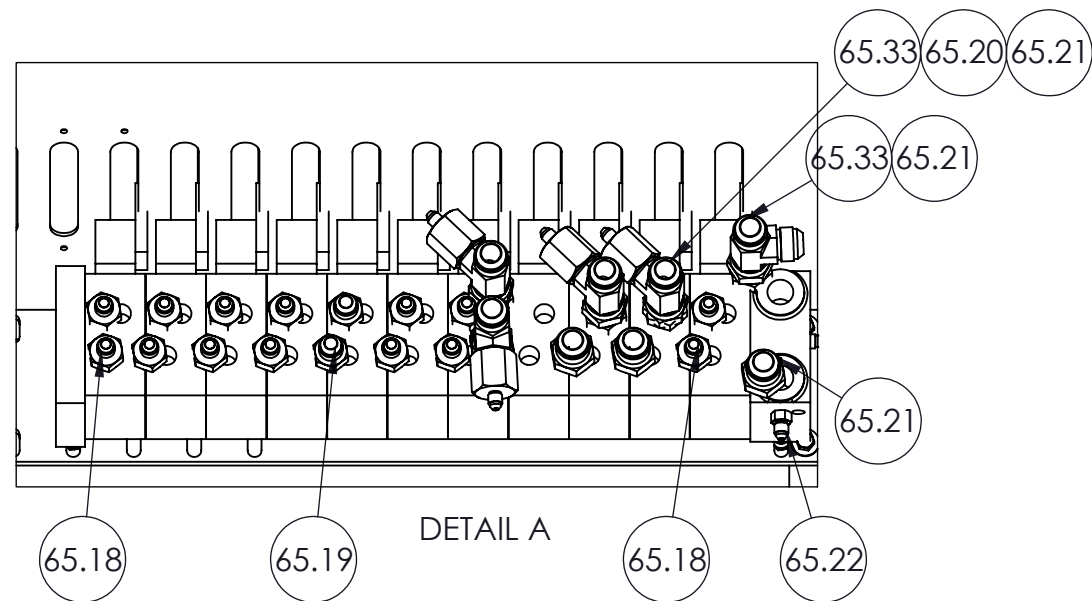
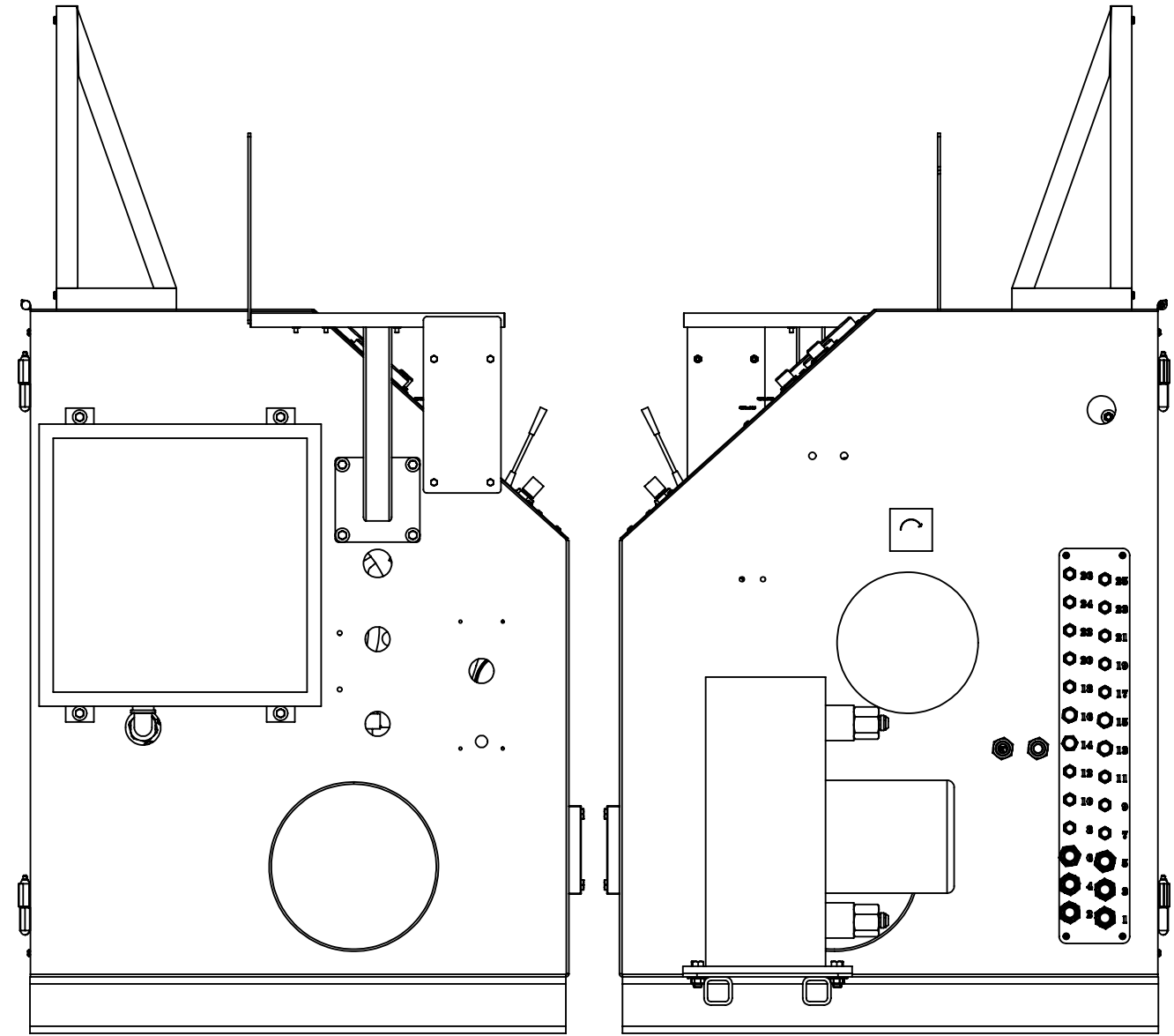
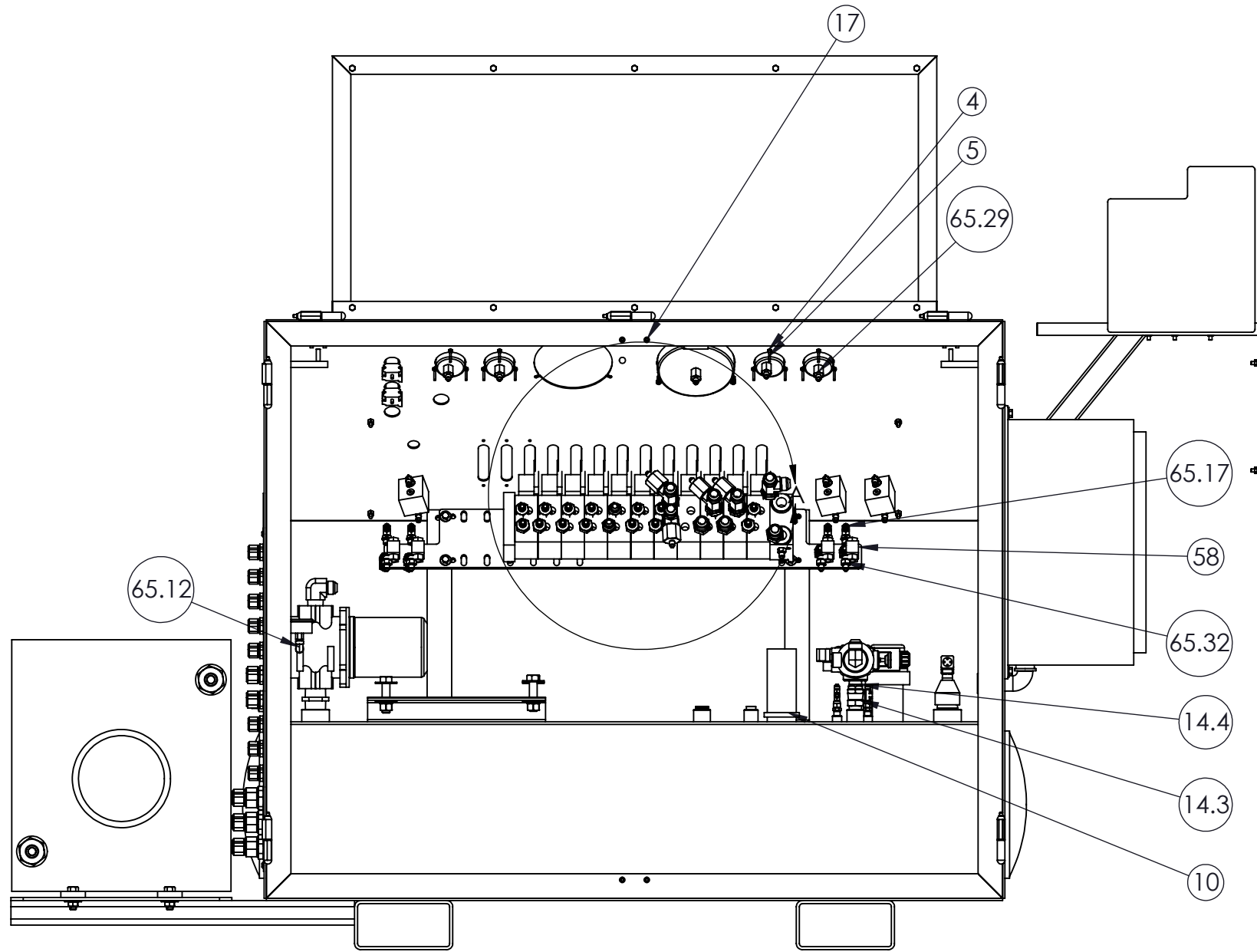

DESCRIPTION		
ASSEMBLY, POWER UNIT/ CONSOLE, 11 BANK, W/ HEAT EXCHANGER		
SIZE B	PART NO. RP5047-7006	REV B
MATERIAL	N/A	SHEET 6 OF 7

SHOWN WITHOUT MULTIPLE PARTS FOR CLARITY

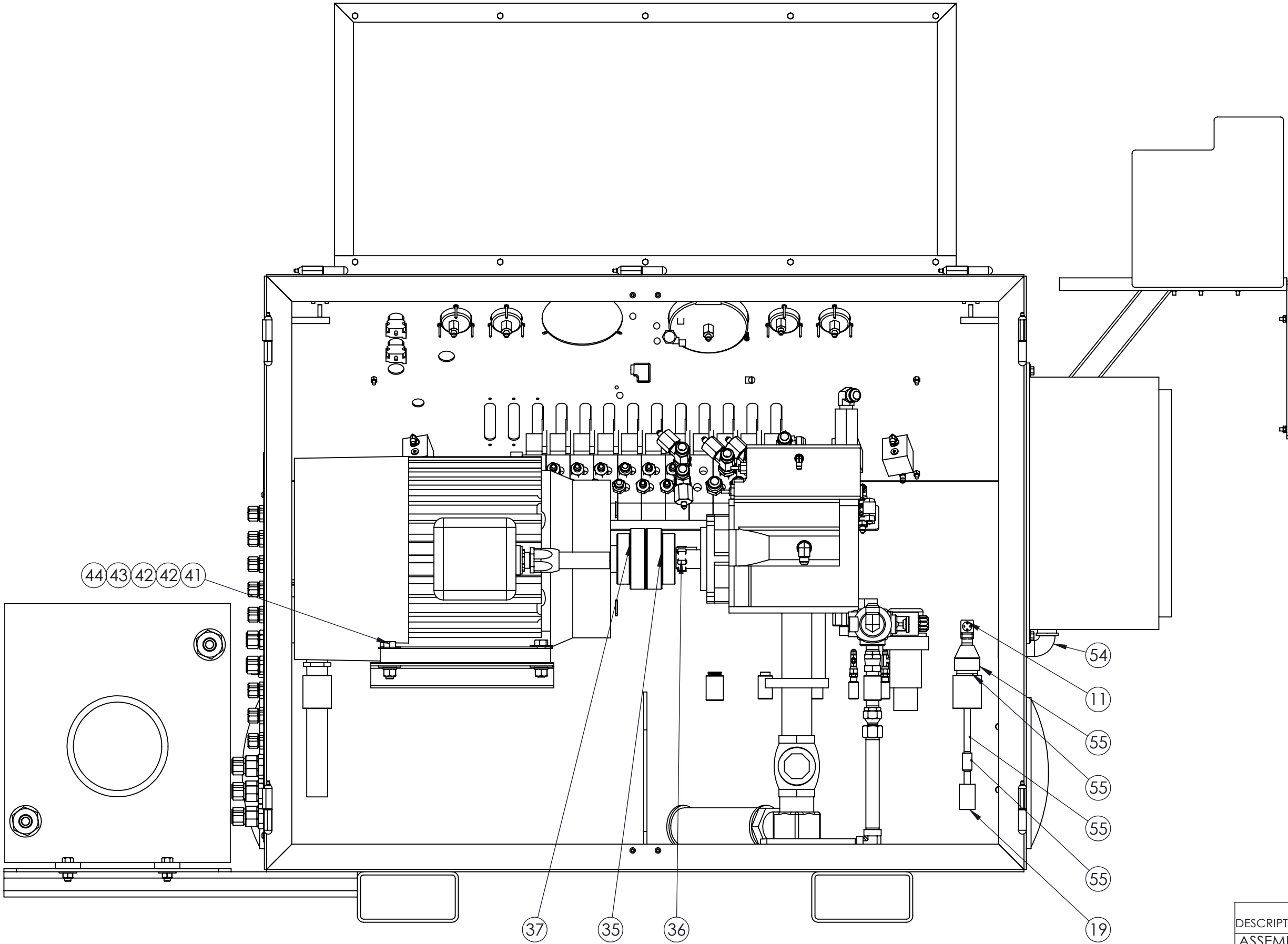

DESCRIPTION			
ASSEMBLY, POWER UNIT/ CONSOLE, 11 BANK, W/ HEAT EXCHANGER			
SIZE	PART NO.	REV	
B	RP5047-7006	B	
MATERIAL	N/A	SHEET 7 OF 7	