

ITEM	QTY	P/N	DESCRIPTION
1	1	500-6012-12	ASSEMBLY, SKID, 12 FT
2	1	200-6016-1	ASSEMBLY, TONG
3	1	300-6516	ASSEMBLY, BACKUP, 16.5 INCH
4	1	3000-6500-03	ASSEMBLY, HEAD GUARD, 16.5 INCH
5	1	RP NUMBERS	PLATE, TAG, NUMBERS
6	8	DTI1602	DIE, DOVETAIL, 1.25W, .5T, 5L, STRAIGHT TOOTH

BUCKING UNIT SPECIFICATIONS		
MAX TORQUE	50,000 ft-lbs	67,800 N-m
SYSTEM PRESSURE	3,000 PSI	207 Bar
ARM LENGTH	24 Inches	61cm
MASS	11,000 Lbs.	5,000 kg
SPEED (RPM, ESTIMATED)		
AT FLOW RATE (GPM/LPM):	26.4 GPM	100 LPM
LOW GEAR	3.5 RPM	
HIGH GEAR	17.1 RPM	

NUMBER OF JAWS	PIPE SIZE (IN)	MAX. TORQUE @ 2,000 PSI (ft-lb)	MAX. TORQUE @ 1,800 PSI (ft-lb)	MAX. TORQUE @ 1,500 PSI (ft-lb)	MAX. TORQUE @ 1,000 PSI (ft-lb)
4 JAWS	7.625 - 16.000	50,000			
	6.625	50,000	50,000	50,000	49,500
	5.625				42,000
	5.500				41,100
	5.000				37,300
	4.500				33,600
	4.000	44,800	29,900		
	3.500	47,000	39,200	26,100	
	3.000	44,800	40,300	33,600	22,400
	2.875	42,900	38,600	32,200	21,500
2.375	35,500	31,900	26,600	17,700	

NOTES:

- 1) THIS TABLE REPRESENTS THE THEORETICAL TORQUE AT WHICH THE DIES WILL SLIP ON THE TUBULAR
- 2) THIS UNIT REQUIRES AND RP5047-6XXX MODEL CONTROL CONSOLE TO OPERATE

REVISIONS				
REVISION	ECO NUMBER	ECO DESCRIPTION	ECO COMPLETED BY	ECO COMPLETED DATE
1	12-0951	ADDED GUSSETS AND WELDMENT SHEET	J.S	2012
A	17-0111	UPDATED GA DRAWING TO NEW FORMAT	J. KELLY	2017

  

UNLESS OTHERWISE SPECIFIED:		PROPRIETARY STATEMENT		DESCRIPTION	
1. DIMENSIONS ARE IN INCHES	THIS DOCUMENT IS THE PROPERTY OF MCCOY CORPORATION AND IS CONSIDERED CONFIDENTIAL. THIS INFORMATION MAY NOT BE USED, DISCLOSED, COPIED, OR REPRODUCED IN ANY FORM, WITHOUT THE EXPRESS WRITTEN CONSENT OF MCCOY CORPORATION.				
2. TOLERANCES: ANGULAR ± 1° FRACTIONAL ± 1/16 TWO PLACE DECIMAL ± 0.02 THREE PLACE DECIMAL ± 0.005					
3. IDENTIFY P/N & MAIL P.O. USING 1/8 TO 1/4 ETCHED LETTERS, DENOTED BY "X"		DRAWN	J. KELLY	01/21/2013	ASSEMBLY, BUCKING UNIT, 16 BACKUP, 50K BREAKOUT, 12 FT
4. REMOVE BURRS & SHARP EDGES WITH 1/64x45° MAX		CHECKED	J. KELLY		SIZE PART NO.
5. MACHINED FILET RADI SHALL BE 1/32		APPROVED	J. KELLY		B RP6016-01
6. FINAL SURFACE ROUGHNESS AVG. (Ra) SHALL BE ≤ 250 MICROINCHES		THIRD ANGLE PROJECTION		WEIGHT	REV
7. □ DENOTES CRITICAL DIMENSION: 100% INSPECTION REQUIRED		11014 LBS.		MATERIAL	A
8. A TRIANGLE DENOTES A REVISION				N/A	SHEET 1 OF 2
9. INTERPRET DRAWING PER ASME Y14.5-2009					

RELEASED FOR PRODUCTION

# STANDARD ACCESSORIES

HYDRAULIC SUPPORT STAND

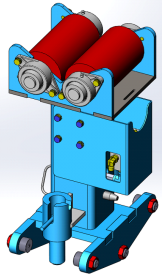

HYDRAULIC POWERED V-ROLLER SUPPORT STAND

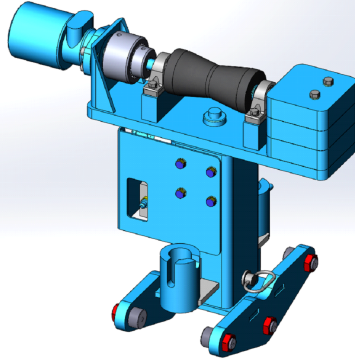

HYDRAULIC NON-POWERED V-ROLLER SUPPORT STAND

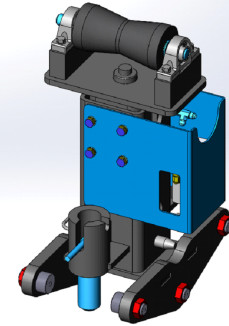

HYDRAULIC TRANSFER BALL ROLLER SUPPORT STAND

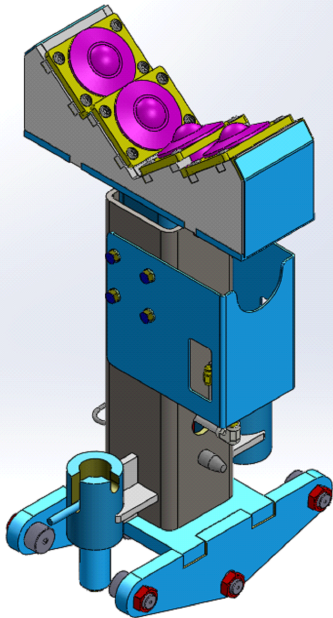

PUSH PULL

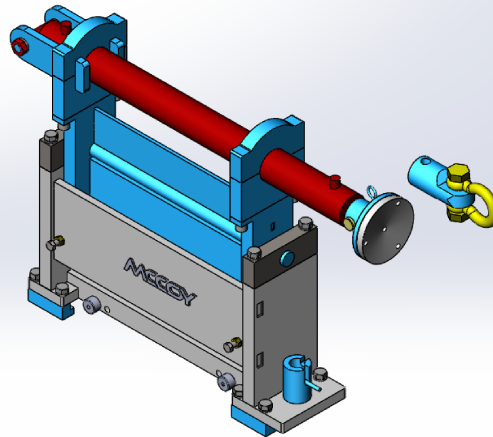

EXTENSION BEAM  
(AVAILABLE FROM 6' TO 20')

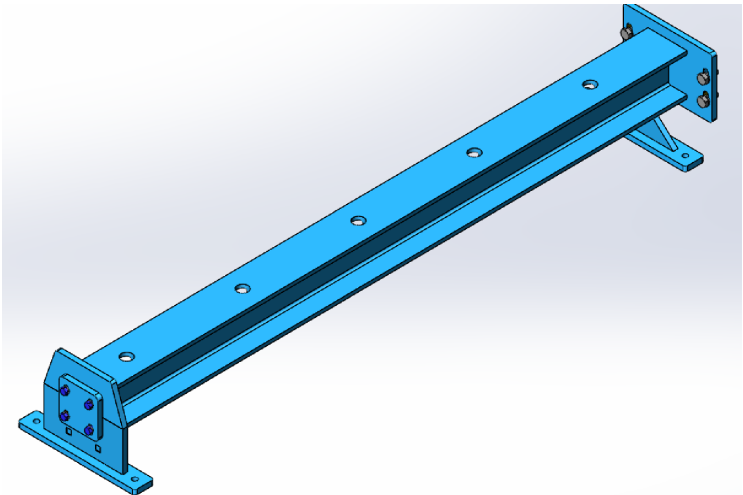

DESCRIPTION		
ASSEMBLY, BUCKING UNIT, 16 BACKUP, 50K BREAKOUT, 12 FT		
SIZE	PART NO.	REV
A	RP6016-01	A
MATERIAL	N/A	SHEET 2 OF 2