

ITEM	Qty.	P/N	DESCRIPTION
1	1	500-7018-12	ASSEMBLY, SKID, 12 FT
2	1	300-7018-01	ASSEMBLY, BACKUP, 18
3	1	200-7018-2	ASSEMBLY, TONG, 18
4	1	3000-7000-5	ASSEMBLY, COVER

BUCKING UNIT SPECIFICATIONS		
MAX TORQUE	105,000 ft-lbs	142,000 N-m
SYSTEM PRESSURE	3,000 PSI	207 Bar
ARM LENGTH	36 Inches	91cm
MASS	19,700 Lbs.	8,900 kg
SPEED (RPM, ESTIMATED)		
AT FLOW RATE (GPM/LPM):	26.4 GPM	100 LPM
LOW GEAR	1.8 RPM	
HIGH GEAR	7.3 RPM	

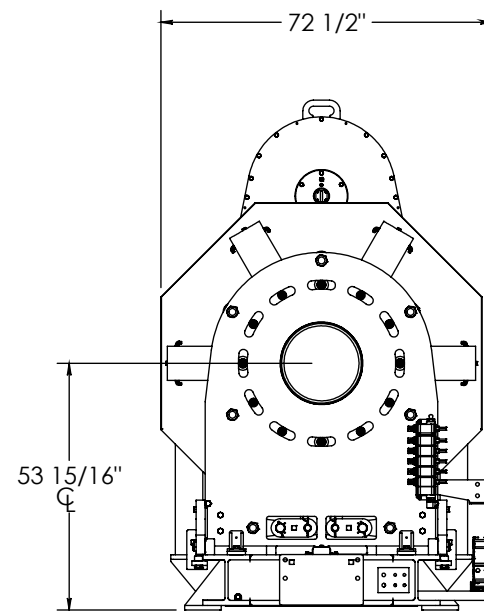
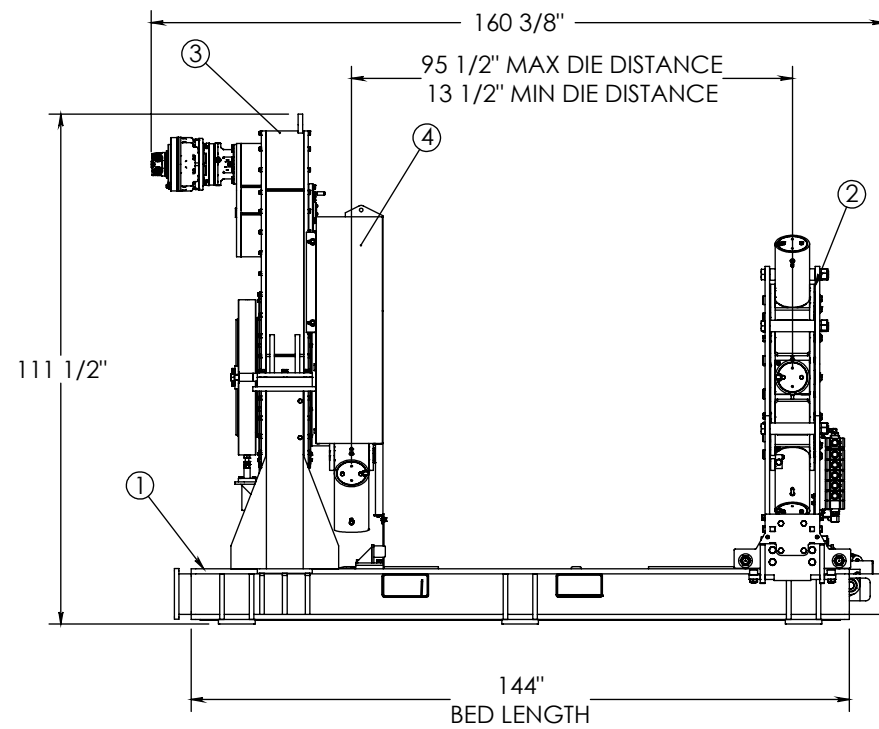

NUMBER OF JAWS	PIPE SIZE (IN)	MAX. TORQUE @ 2,000 PSI (ft-lb)	MAX. TORQUE @ 1,800 PSI (ft-lb)	MAX. TORQUE @ 1,500 PSI (ft-lb)	MAX. TORQUE @ 1,000 PSI (ft-lb)
6 JAWS	9.625 - 17.400	105,000			
	8.875	105,000	105,000	105,000	99,300
	7.625				85,300
	7.000				78,300
	6.625				74,100
	5.625				62,900
	5.500				61,500
	5.000	100,700	83,900	55,900	
	4.500	100,700	90,700	75,500	50,300
	4.000	89,500	80,600	67,100	44,700
3 JAW	3.500	78,300	70,500	58,700	39,100
	3.000	33,500	30,200	25,100	16,700
	2.875	32,100	28,900	24,100	16,000
	2.375	26,500	23,900	19,900	13,200

NOTES:

- 1) THIS TABLE REPRESENTS THE THEORETICAL TORQUE AT WHICH THE DIES WILL SLIP ON THE TUBULAR
- 2) THIS UNIT REQUIRES AND RP5047-7XXX MODEL CONTROL CONSOLE TO OPERATE

REVISIONS				
REVISION	ECO NUMBER	ECO DESCRIPTION	ECO COMPLETED BY	ECO COMPLETED DATE
1	13-0499	REPLACED HEADSTOCK GUARD	JK	2013
A	17-0111	UPDATED DRAWING TO NEW GA FROMAT	J. KELLY	2017

  

<small>UNLESS OTHERWISE SPECIFIED:</small> 1. DIMENSIONS ARE IN INCHES 2. TOLERANCES: ANGULAR ± 1° FRACTIONAL ± 1/16 TWO PLACE DECIMAL ± 0.02 THREE PLACE DECIMAL ± 0.005 3. IDENTIFY P/N & MAIL P.O. USING 1/8 TO 1/4 ETCHED LETTERS; DENOTED BY "X" 4. REMOVE BURRS & SHARP EDGES WITH 1/64x45° MAX 5. MACHINED FILET RADII SHALL BE 1/32 6. FINAL SURFACE ROUGHNESS AVG. (Ra) SHALL BE ≤ 250 MICROINCHES 7. ○ DENOTES CRITICAL DIMENSION; 100% INSPECTION REQUIRED 8. A TRIANGLE DENOTES A REVISION 9. INTERPRET DRAWING PER ASME Y14.5-2009	<small>PROPRIETARY STATEMENT</small> THIS DOCUMENT IS THE PROPERTY OF MCCOY CORPORATION AND IS CONSIDERED CONFIDENTIAL. THIS INFORMATION MAY NOT BE USED, DISCLOSED, COPIED, OR REPRODUCED IN ANY FORM, WITHOUT THE EXPRESS WRITTEN CONSENT OF MCCOY CORPORATION.			
	DRAWN	RM	12/02/11	DESCRIPTION
	CHECKED	RM		ASSEMBLY, BUCKING UNIT, 17.4-105K
	APPROVED	RM		SIZE PART NO. RP7018
THIRD ANGLE PROJECTION	WEIGHT	19702 LBS.	MATERIAL	N/A
			REV A	SHEET 1 OF 2

RELEASED FOR PRODUCTION

# STANDARD ACCESSORIES

HYDRAULIC SUPPORT STAND

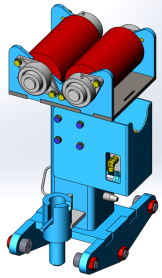

HYDRAULIC POWERED V-ROLLER SUPPORT STAND

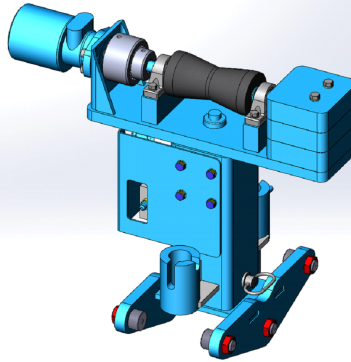

HYDRAULIC NON-POWERED V-ROLLER SUPPORT STAND

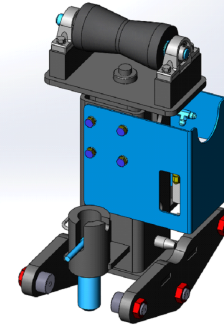

HYDRAULIC TRANSFER BALL ROLLER SUPPORT STAND

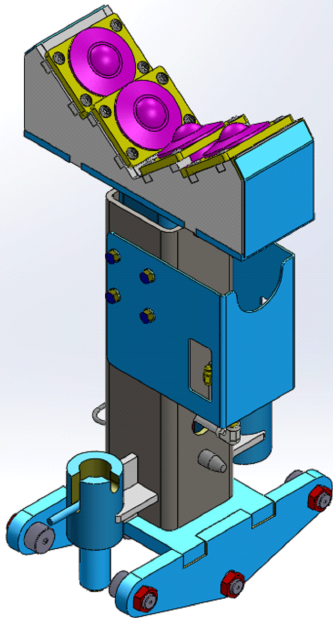

PUSH PULL

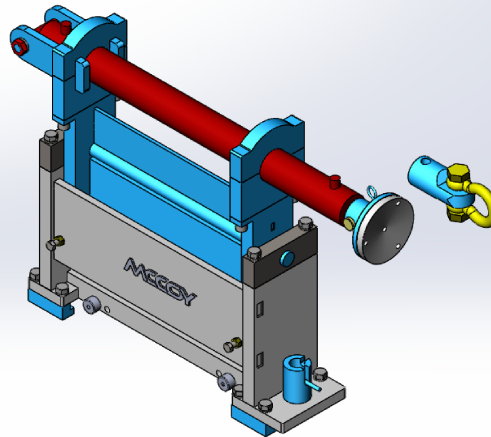

EXTENSION BEAM  
(AVAILABLE FROM 6' TO 20')

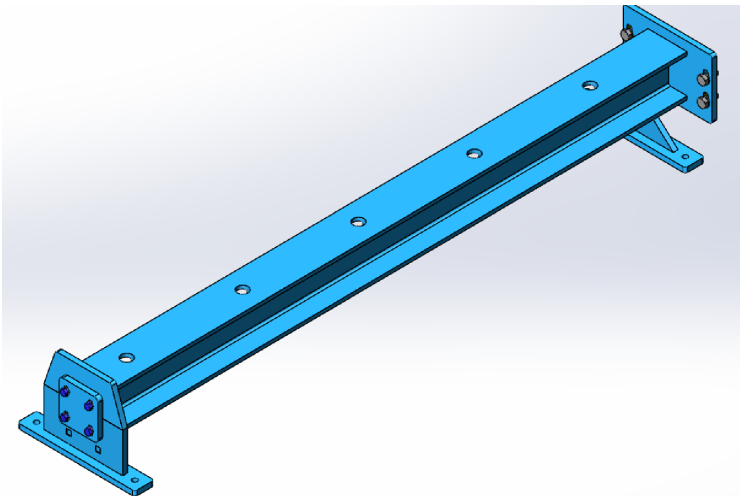

DESCRIPTION		
ASSEMBLY, BUCKING UNIT, 17.4-105K		
SIZE	PART NO.	REV
A	RP7018	A
MATERIAL		SHEET 2 OF 2
N/A		