

ITEM	Qty.	P/N	DESCRIPTION
1	1	200-7000-22A	ASSEMBLY, VISE, TONG
2	1	3000-7000	ASSEMBLY, GUARD, TONG
3	1	300-7022	ASSEMBLY, BACKUP, HINGED, 22-105K
4	1	500-7022-12	ASSEMBLY, SKID, 12 FEET
5	2	CB11001-01-S5	PLATE, MOUNT
6	1	KITBOLT-49	BOLT KIT
7	1	KITBRG-46	BEARING KIT
8	1	KITFIT-47	FITTING KIT

BUCKING UNIT SPECIFICATIONS		
<b>MAX TORQUE</b>	105,000 ft-lbs	142,000 N-m
<b>SYSTEM PRESSURE</b>	3,000 PSI	207 Bar
<b>ARM LENGTH</b>	36 Inches	91cm
<b>MASS</b>	18,400 Lbs.	8,300 kg
SPEED (RPM, ESTIMATED)		
<b>AT FLOW RATE (GPM/LPM):</b>	26.4 GPM	100 LPM
<b>LOW GEAR</b>	2.7 RPM	
<b>HIGH GEAR</b>	7.7 RPM	

NUMBER OF JAWS	PIPE SIZE (IN)	MAX. TORQUE @ 1,000 PSI (ft-lb)
6 JAWS	9.625 - 22.500	105,000
	8.875	99,300
	7.625	85,300
	7.000	78,300

NOTES:

- 1) THIS TABLE REPRESENTS THE THEORETICAL TORQUE AT WHICH THE DIES WILL SLIP ON THE TUBULAR
- 2) THIS UNIT REQUIRES AND RP5047-7XXX MODEL CONTROL CONSOLE TO OPERATE
- 3) THE CLAMP CYLINDERS ARE RATED FOR 2,000 PSI, HOWEVER THE USER SHOULD NOT EXCEED THE TORQUE VALUES LISTED ON THE TABLE.

RELEASED FOR PRODUCTION

REVISIONS				
REVISION	ECO NUMBER	ECO DESCRIPTION	ECO COMPLETED BY	ECO COMPLETED DATE
A	17-0111	UPDATED GA DRAWING TO NEW FORMAT	J. KELLY	2017

<small>UNLESS OTHERWISE SPECIFIED:            1. DIMENSIONS ARE IN INCHES            2. TOLERANCES:            ANGULAR ± 1°            FRACTIONAL ± 1/16            TWO PLACE DECIMAL ± 0.02            THREE PLACE DECIMAL ± 0.005            3. IDENTIFY P/N &amp; MAIL P.O. USING 1/8 TO 1/4 ETCHED LETTERS, DENOTED BY "X"            4. REMOVE BURRS &amp; SHARP EDGES WITH 1/64x45° MAX            5. MACHINED FILET RADII SHALL BE 1/32            6. FINAL SURFACE ROUGHNESS AVG. (Ra) SHALL BE ≤ 250 MICROINCHES            7. ○ DENOTES CRITICAL DIMENSION: 100% INSPECTION REQUIRED            8. A TRIANGLE DENOTES A REVISION            9. INTERPRET DRAWING PER ASME Y14.5-2009</small>	<b>PROPRIETARY STATEMENT</b> <small>THIS DOCUMENT IS THE PROPERTY OF MCCOY CORPORATION AND IS CONSIDERED CONFIDENTIAL. THIS INFORMATION MAY NOT BE USED, DISCLOSED, COPIED, OR REPRODUCED IN ANY FORM, WITHOUT THE EXPRESS WRITTEN CONSENT OF MCCOY CORPORATION.</small>				
	DRAWN	J.KELLY	03/21/2013	DESCRIPTION ASSEMBLY, BUCKING UNIT, 22-105K, HINGED TS, 12 FT	
	CHECKED	J.SUBRAMANIAN		SIZE PART NO. B RP7022-02	
	APPROVED	B.PEARCE		REV A	
THIRD ANGLE PROJECTION		WEIGHT 18365.278 LBS.		MATERIAL N/A	

# STANDARD ACCESSORIES

HYDRAULIC SUPPORT STAND

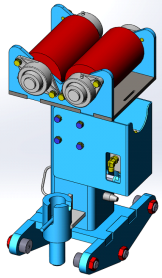

HYDRAULIC POWERED V-ROLLER SUPPORT STAND

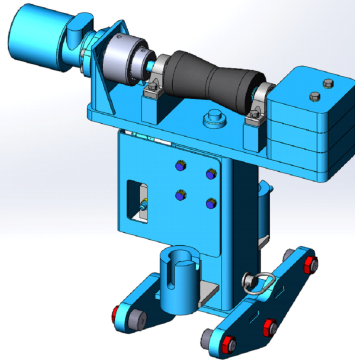

HYDRAULIC NON-POWERED V-ROLLER SUPPORT STAND

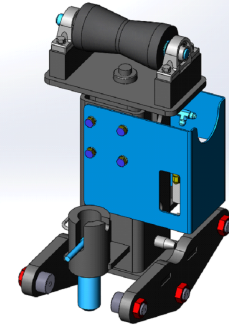

HYDRAULIC TRANSFER BALL ROLLER SUPPORT STAND

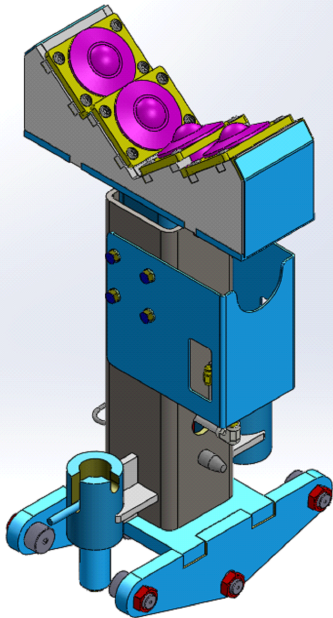

PUSH PULL

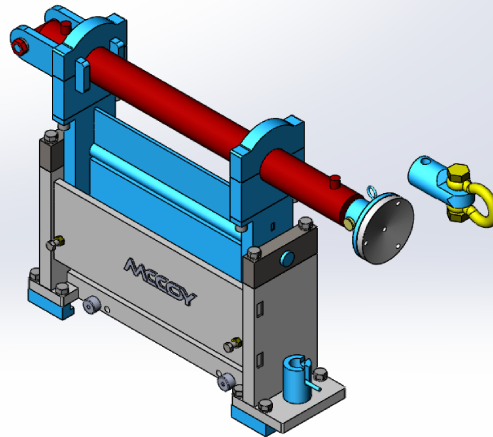

EXTENSION BEAM  
(AVAILABLE FROM 6' TO 20')

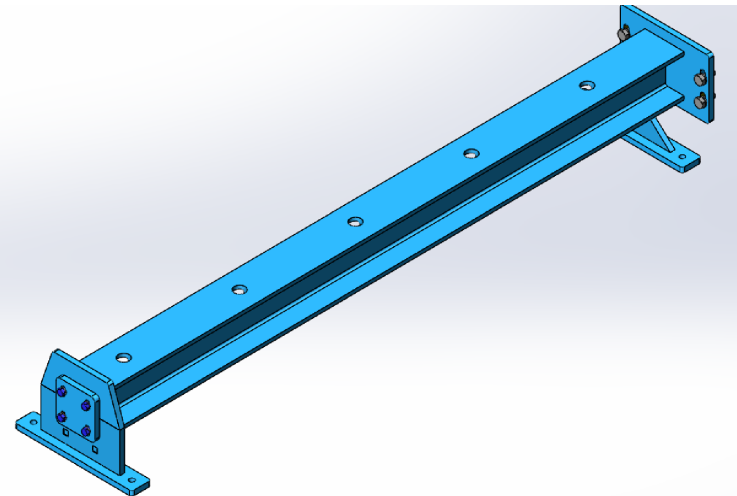

DESCRIPTION		
ASSEMBLY, BUCKING UNIT, 22-105K, HINGED TS, 12 FT		
SIZE	PART NO.	REV
A	RP7022-02	A
MATERIAL	N/A	SHEET 2 OF 2