

ITEM	QTY	P/N	DESCRIPTION
1	1	1002959	ASSEMBLY, SKID, 20 FT
2	2	CB11001-01-S5	PLATE, MOUNT
3	1	200-7000-22A	ASSEMBLY, VISE, TONG
4	1	300-7022-01	ASSEMBLY, BACKUP, 22-105K
5	1	3000-7000	ASSEMBLY, GUARD, TONG
6	1	1002968	ASSEMBLY, RACK, HOSE
7	1	1002984	ASSEMBLY, MANIFOLD
8	1	1003031	ASSEMBLY, BULKHEAD

BUCKING UNIT SPECIFICATIONS		
<b>MAX TORQUE</b>	105,000 ft-lbs	142,000 N-m
<b>SYSTEM PRESSURE</b>	3,000 PSI	207 Bar
<b>ARM LENGTH</b>	36 Inches	91cm
<b>MASS</b>	21,200 Lbs.	9,600 kg
SPEED (RPM, ESTIMATED)		
<b>AT FLOW RATE (GPM/LPM):</b>	26.4 GPM	100 LPM
<b>LOW GEAR</b>	2.7 RPM	
<b>HIGH GEAR</b>	7.7 RPM	

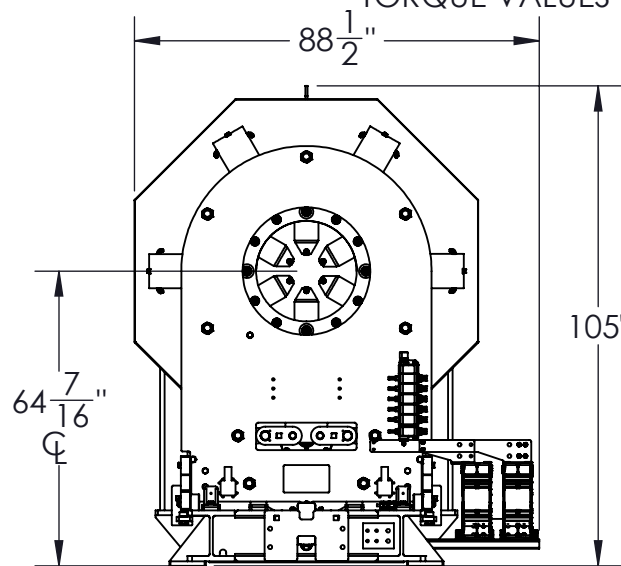
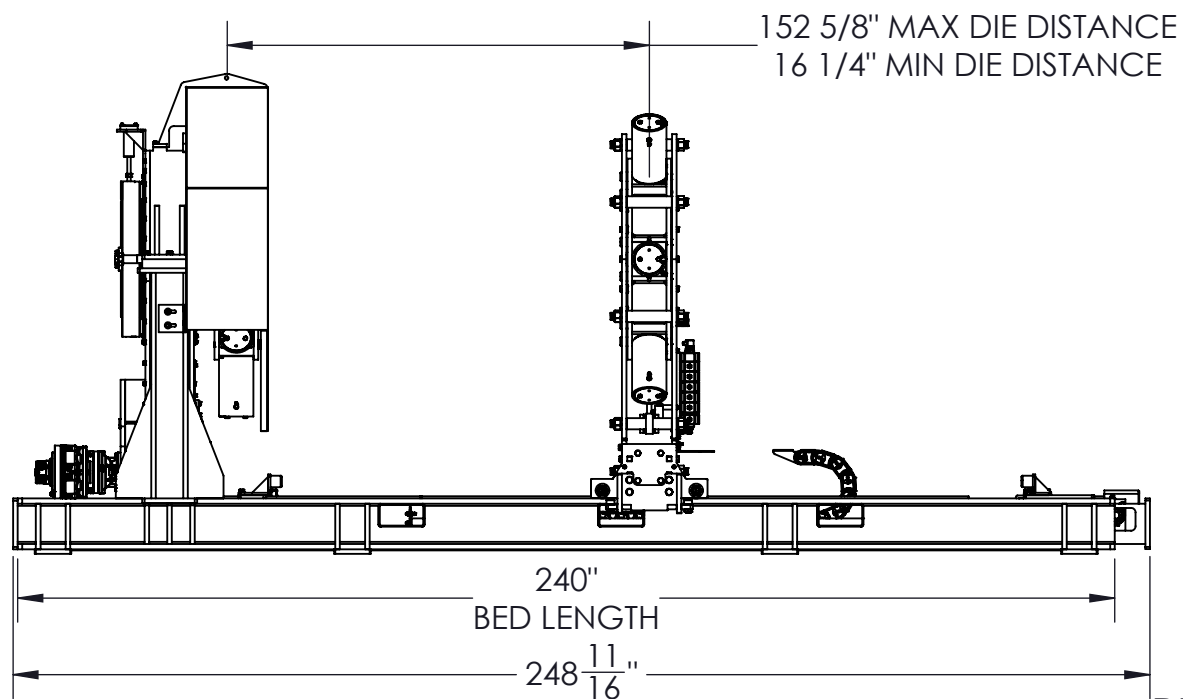
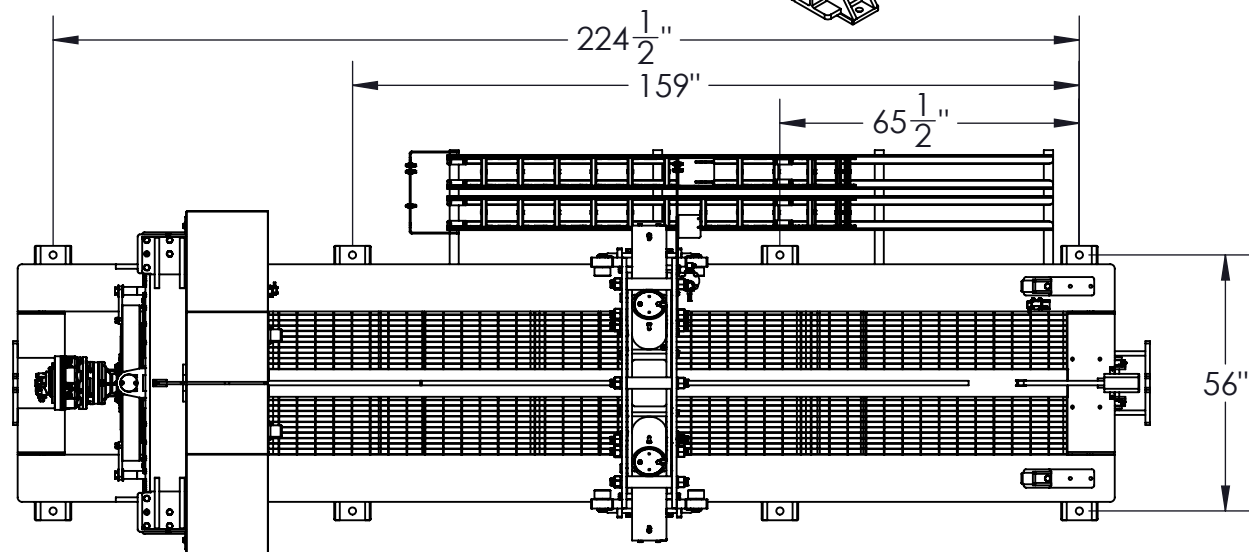

NUMBER OF JAWS	PIPE SIZE (IN)	MAX. TORQUE @ 1,000 PSI (ft-lb)
6 JAWS	9.625 - 22.500	105,000
	8.875	99,300
	7.625	85,300
	7.000	78,300

NOTES:

- 1) THIS TABLE REPRESENTS THE THEORETICAL TORQUE AT WHICH THE DIES WILL SLIP ON THE TUBULAR
- 2) THIS UNIT REQUIRES AND RP5047-7XXX MODEL CONTROL CONSOLE TO OPERATE
- 3) THE CLAMP CYLINDERS ARE RATED FOR 2,000 PSI, HOWEVER THE USER SHOULD NOT EXCEED THE TORQUE VALUES LISTED ON THE TABLE.

RELEASED FOR PRODUCTION

REVISIONS				
REVISION	ECO NUMBER	ECO DESCRIPTION	ECO COMPLETED BY	ECO COMPLETED DATE
B	15-0050	ADDED (1) 1003031	J. KELLY	28/18/15
C	17-0111	UPDATED GA DRAWING TO NEW FORMAT	J. KELLY	2017

UNLESS OTHERWISE SPECIFIED:		PROPRIETARY STATEMENT		MCCOY GLOBAL	
1. DIMENSIONS ARE IN INCHES		THIS DOCUMENT IS THE PROPERTY OF MCCOY CORPORATION AND IS CONSIDERED CONFIDENTIAL. THIS INFORMATION MAY NOT BE USED, DISCLOSED, COPIED, OR REPRODUCED IN ANY FORM, WITHOUT THE EXPRESS WRITTEN CONSENT OF MCCOY CORPORATION.		DESCRIPTION	
2. TOLERANCES: ANGULAR ± 1° FRACTIONAL ± 1/16 TWO PLACE DECIMAL ± 0.02 THREE PLACE DECIMAL ± 0.005		DRAWN J.KELLY 02/08/2015		ASSEMBLY, BUCKING UNIT, 20' RP7022	
3. IDENTIFY P/N & MAIL P.O. USING 1/8 TO 1/4 ETCHED LETTERS, DENOTED BY "X"		CHECKED B.PEARCE 02/09/2015		SIZE PART NO.	
4. REMOVE BURRS & SHARP EDGES WITH 1/64x45° MAX		APPROVED B.PEARCE 02/09/2015		B RP7022-05	
5. MACHINED FILET RADII SHALL BE 1/32		THIRD ANGLE PROJECTION		MATERIAL	
6. FINAL SURFACE ROUGHNESS AVG. (Ra) SHALL BE ≤ 250 MICROINCHES		WEIGHT 21180.9 LBS.		N/A	
7. DISPOSES CRITICAL DIMENSION: 100% INSPECTION REQUIRED		SHEET 1 OF 2		REV C	
8. A TRIANGLE DENOTES A REVISION					
9. INTERPRET DRAWING PER ASME Y14.5-2009					

# STANDARD ACCESSORIES

HYDRAULIC SUPPORT STAND

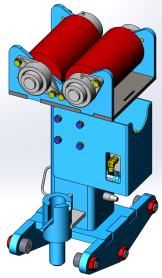

HYDRAULIC POWERED V-ROLLER SUPPORT STAND

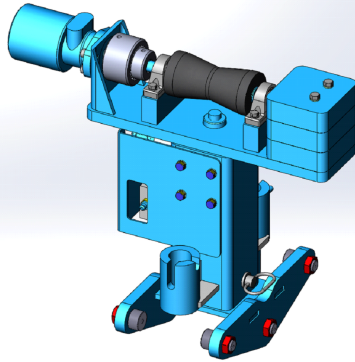

HYDRAULIC NON-POWERED V-ROLLER SUPPORT STAND

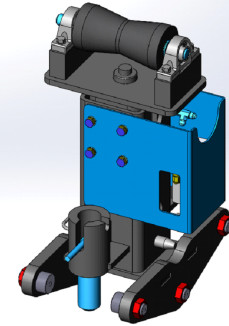

HYDRAULIC TRANSFER BALL ROLLER SUPPORT STAND

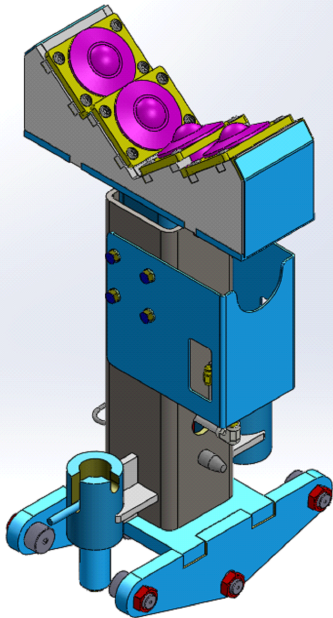

PUSH PULL

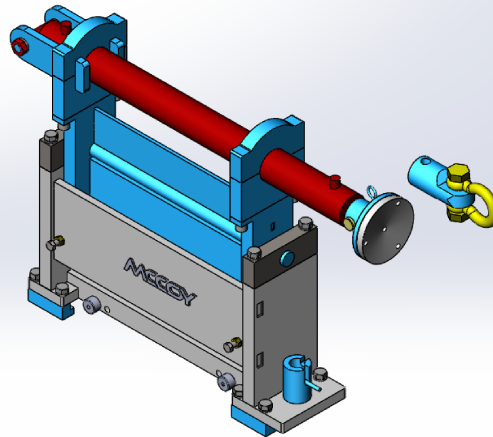

EXTENSION BEAM  
(AVAILABLE FROM 6' TO 20')

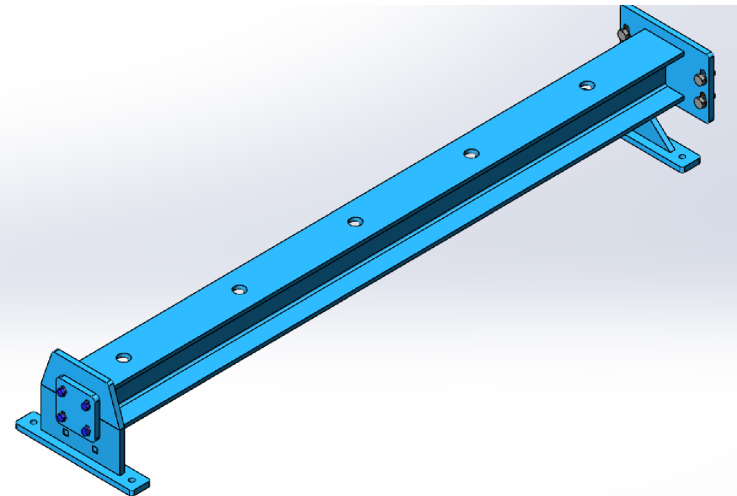

DESCRIPTION		
ASSEMBLY, BUCKING UNIT, 20' RP7022		
SIZE	PART NO.	REV
A	RP7022-05	C
MATERIAL	N/A	SHEET 2 OF 2